

SPECIFICATION :

1. Electrical Char.

Insulation Resistance : 500M-Ohm Min. 500V DC. for 1 minute.
 Contact Resistance : 30milli-Ohm Max.
 Rating Current : 1.5A Max.
 Rating Voltage : 150V AC.
 Dielectric Voltage : 1,000 Vrms at 1MA 60 Sec. Min.

2. Physical char.

Housing (Option) : For Waving Soldering Process
 PBT Glass Filled (UL 94V-0),Soldering Temperature:235°C for 5 Sec.
 Nylon (UL 94V-0),Soldering Temperature:260°C for 5 Sec.
 Color : Black Color
 Spring Wire :
 0.45mm Dia. Phosphor bronze Gold Plating Over Nickel.
 Temperature Range : - 40°C / +85°C
 Durability : 750 Mating cycles Min.

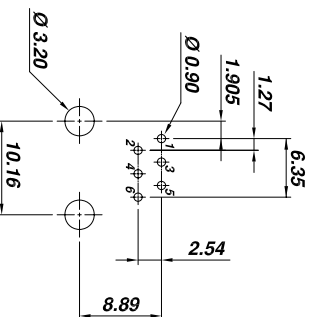
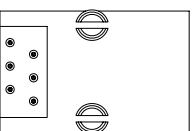
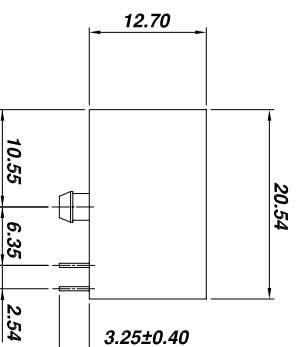
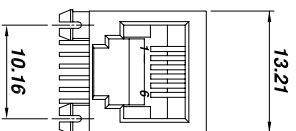

PCB LAYOUT
(Top View)

AJ-007-6-X-XX-N

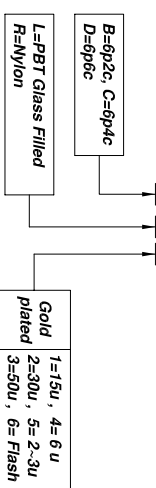

ALLSUN CORPORATION
 9FL,NO.292 SEC.7 CHENG TEH ROAD,TAIPEI TAIWAN.
 E - mail Address : allsun@globalsources.com

TITLE
 RJ11 or RJ12 SIDE ENTRY PCB JACK
 UL & CUL FILE NO. E131820

MODULAR JACKS ASSY FOR
AJ-007-6-X-XX-N

SCALE SIZE DWG. NO. 9636 SERIES

NOT SCALED DRAWING	TOLERANCE UNLESS OTHERWISE NOTICE	INCH	MM	DR.	DATE
THIRD ANGLE PROJECTION	LINEAR	.002±0.01 .000±0.005 .0000±0.002	.002±0.25 .000±0.13 .0000±0.05	CK'D <i>John</i> APP'D <i>Billy</i>	MAY-31 '13 MAY-31 '13 MAY-31 '13
DWG. NO.	ANGLE +0° 30'	RADI	+0.45 -0.15		

AST007A04-2